

# MOPKING®

Multi-Function Spin-Dry Bucket

i n s t r u c t i o n s

THE ONLY ONE SPIN-DRY BUCKET IS CAPABLE OF  
DRYING TO DIFFERENT TYPES OF MOP IN THE WORLD.



From now on, MOPKING® want you to  
choose mops more free & dry mops more easily

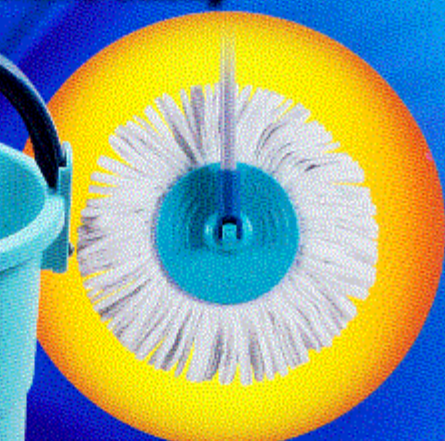

## FEATURES

Capable of drying to several types of mop

Multi-function design, excellent value for money

Super-rotation torque mechanism device leads to spin heavy moisture off the mops very easy

• MULTINATIONAL PATENTS PRESERVED •

## PARTS INSTRUCTIONS OF MOPKING® MULTI-FUNCTION SPIN-DRY BUCKET



## STEPS OF SPIN-DRY TO MOPKING® 360° SWIVEL ROUND PLATE MOP



**STEP 1**  
Clean the mop cloth in water.  
(Do not pour water over the line of maximum water level.)



**STEP 2**  
Place mop plate and cloth completely in spin-dry trough. (Due to the swivel round plate mop's rod location has been fixed in center, there no need to use such a bucket handle to hold the mop rod.)



**STEP 3**  
One hand holds sleeve grip of top section of mop rod, then one foot steps up and down several times on pedal board. (In accordance with dry or humidity of cloth required, you can control the number of pedaling by yourselves.) Pick up the mop to use again or store it after the pedaling.

### ● VERY IMPORTANT, PLEASE PAY ATTENTION TO READ BELOW BEFORE USE ●

1. Please pay attention of the whole matter in accordance with Steps of spin-dry to the mop and Instructions rules.
2. Any mop's size is not applicable to the Instructions rules. it is not recommended to use.
3. Do not to pour over the line of maximum water level while spinning-dry to the mop.
4. Before pedaling, make sure mop cloth has been placed completely in spin-dry trough.
5. Note the use of environmentally safe, do not use on uneven ground while step on pedal board of bucket.
6. Once the foot is pedaling, do not seize the mop tightly to the rotating rod suddenly.
7. For the sake of comfort and efficiency, the heel has to be off ground during the pedaling.
8. Do not demolish deliberately or assemble the bucket's internal built-in mechanism device and external parts.
9. Do not use water or detergent to clean the bucket's internal built-in mechanism device, in order to avoid spare parts oxidation or deterioration.

## STEPS OF SPIN-DRY TO TRADITIONAL MOPS

### 1 Pour clean water in bucket.



Do not pour over the line of maximum water level.

### 2 Choose applicable mop rod holder.

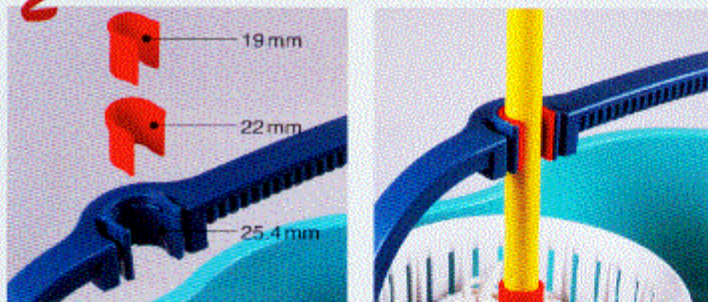

There are three (3) sizes of diameter of mop rod holder in (Small-sized) 19 mm, (Middle-sized) 22 mm and (Big-sized) 25.4 mm are capable of holding the mop rod.

### 3 Clean mop cloth



Hold the mop rod upward and downward thus can clean the mop cloth evenly in water.

### 4 Place mop cloth completely in spin-dry trough.



Place mop rod and mop head in central position of spin-dry trough.

### 5 Make the mop rod held.



One hand lifts up bucket handle and place in central position, at the same time, the other hand place the mop rod in mop rod holder.

### 6 Make bucket handle fixed



One hand presses bucket handle down into both sides of slide grooves upon the mop rod held. And make sure both ends of bucket handle are in the bottom of slide grooves. Then the action of fixation is completed.

### 7 Spin-dry to mop

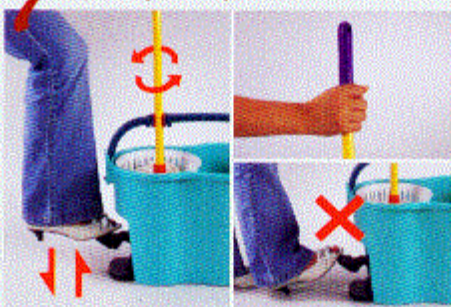

One hand slightly holds (not tight) to mop rod, then one foot steps up and down several times on pedal board. (In accordance with dry or humidity of cloth required, you can control the number of pedaling by yourselves.)

### 8 Release mop rod

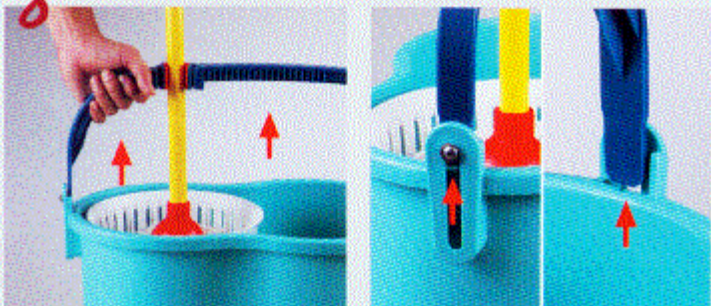

One hand pulls up the bucket handle to the top position of both sides of slide grooves after the pedaling, then the other hand makes the mop rod leaving the mop rod holder.

### 9 Pick up the mop



Put down the bucket handle and pick up the mop to use again or store it.

# MOPKING®

Multi-Function Spin-Dry Bucket

- ALWAYS INSIST ON GOOD QUALITY

- CREATE A BETTER LIFE FOR YOU

PCT APPLICATION AT WIPO



Made in Taiwan